

Technical data-sheet Welding-head SK-2012

Name and address of manufacturer: **KombiTec GmbH**
Westendstraße 5
D-87488 Betzigau / Germany

Tel: +49 (0) 831 / 960 398 - 0
Fax: +49 (0) 831 / 960 398 - 10

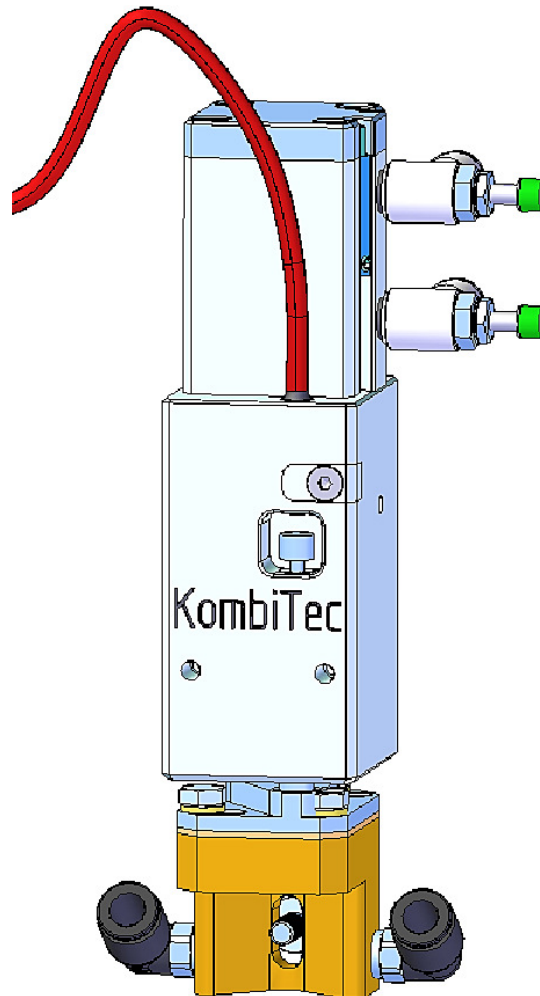

Benefits:

- Compact, but highly flexible design with lowest possible weight
- High dynamic due to smallest moved mass
- Total weight only 0,432 kg
- Wear-free cylinder
- Precise change of electrodes with quick-hitch-system
- Welding-head for up to max. 15 N welding force
- Due to modular principle highest compatibility to other KombiTec products
- Precise positioning-accuracy, stability and robustness due to pre-stressed ball-bearings
- Highest reproducibility through shape-connection
- Outstanding repositioning behaviour due to unstressed anti-torsion units
- Simple adjusting of sensors and stroke
- Simple upgrading opportunities of distance-control and force measuring devices
- As well suitable in double-head welding application

Application areas:

Suitable for all weldings, where small forces are required, like:

- Lightning industry: small contacts, filaments,
- Automotive industry: moulded plastic-parts
- Mechanical engineering: Welding of thin parts and metal sheets
- Energy technique: thin contacts for solar power generators and sensors
- Cable: connection to plugs / to contacts
- Production of consumption goods: Heaters, cooking-pots,

Technical changes:

Technical modification and price changes without notices. All dimensions are in „mm“. No liability can be accepted for printing errors.

Technical data:

Infeed unit:	pneumatically driven cylinder with \varnothing 18 mm
Theoretical force (at 6 bar):	out driving 140 N
Medium pressed air:	filtered 5 μ m, free of water / dried, oiled or un-oiled
Pneumatic fittings:	G1/4"
Pneumatic hose:	\varnothing 6 mm
Working pressure:	3 – 5 bar
Working temperature:	0° C – 60° C
Repeatability:	\pm 0,01 mm
Max. weight of electrode holders:	< 1,0 kg
Max. stroke:	8 mm
Air consumption per cycle:	0,01 L (at 5 bar and max. stroke)
Total weight:	0,45 kg
Max. current:	3,0 kA at 20 ED

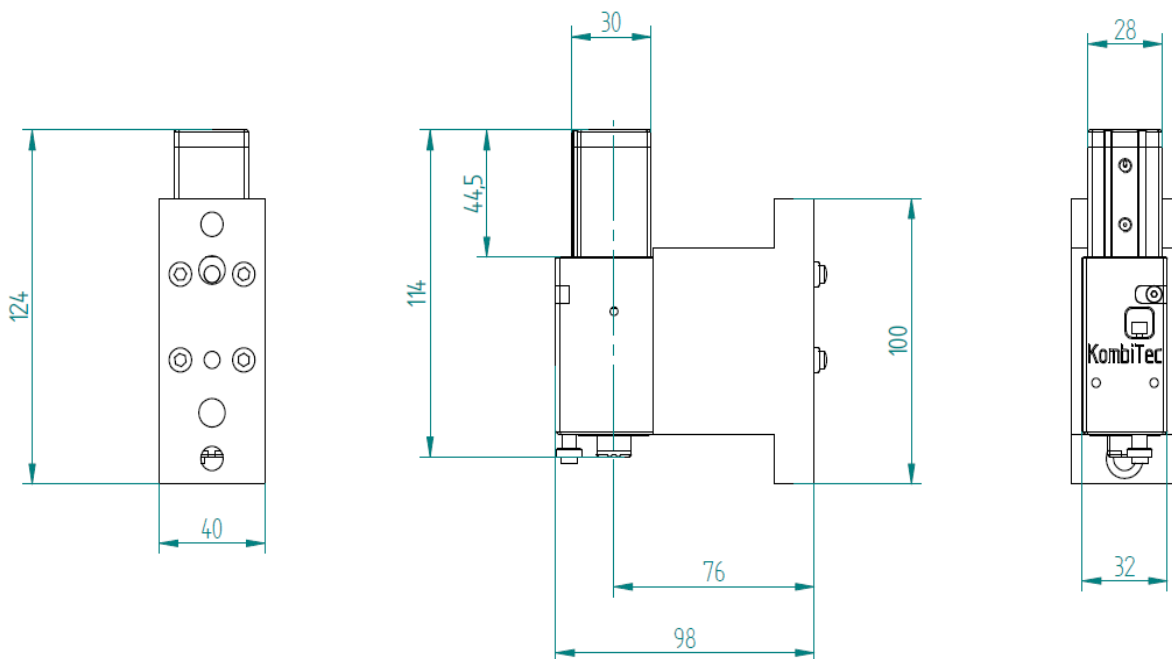

Welding-head SK-2012

Options for configuration:

